

OBERFELD SNOWCAP

FOR LEASE ↘

375 Boulevard Wilfrid-Hamel

Québec, QC

Complexe Santé Quartier Central

Manon Larose *

Managing Director
Commercial Real Estate Services
438.990.8968
manonl@oberfeldsnowcap.com

*Chartered real estate broker, DA

Michelle Marcotte-Blart **

Director
Commercial Real Estate Services
514.972.6163
michelle@oberfeldsnowcap.com

**Commercial real estate broker



Overview

SQUARE FOOTAGE

791 SF - 2,097 SF

ADDRESS

375 Boulevard Wilfrid-Hamel, Québec, QC

AVAILABILITY

Immediate

NET RENT

Ask listing brokers

ADDITIONAL RENT

Approximately 14 \$ PSF

IN A REVITALIZING AREA OF
THE DESJARDINS DISTRICT



PROXIMITY TO MAIN
HIGHWAYS & BOULEVARDS



EASILY ACCESSIBLE
BY BUS



AMPLE WINDOWS FOR
NATURAL LIGHT

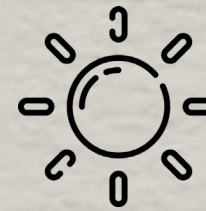

**OBERFELD
SNOWCAP**

Area Demographics

RADIUS : 10KM

2024 Population
560,399

Total Households
278,534

2024 Daytime Population
640,677

Average Household
Income
CA\$99,663

Median Age
44.5

Average Household
Expenditure
CA\$91,553



Key Facts

Demographic Data Source: Piipoint

Plan

Still in development stage which means there is a lot of flexibility concerning uses / unit sizes.

In front of Fleur de Lys

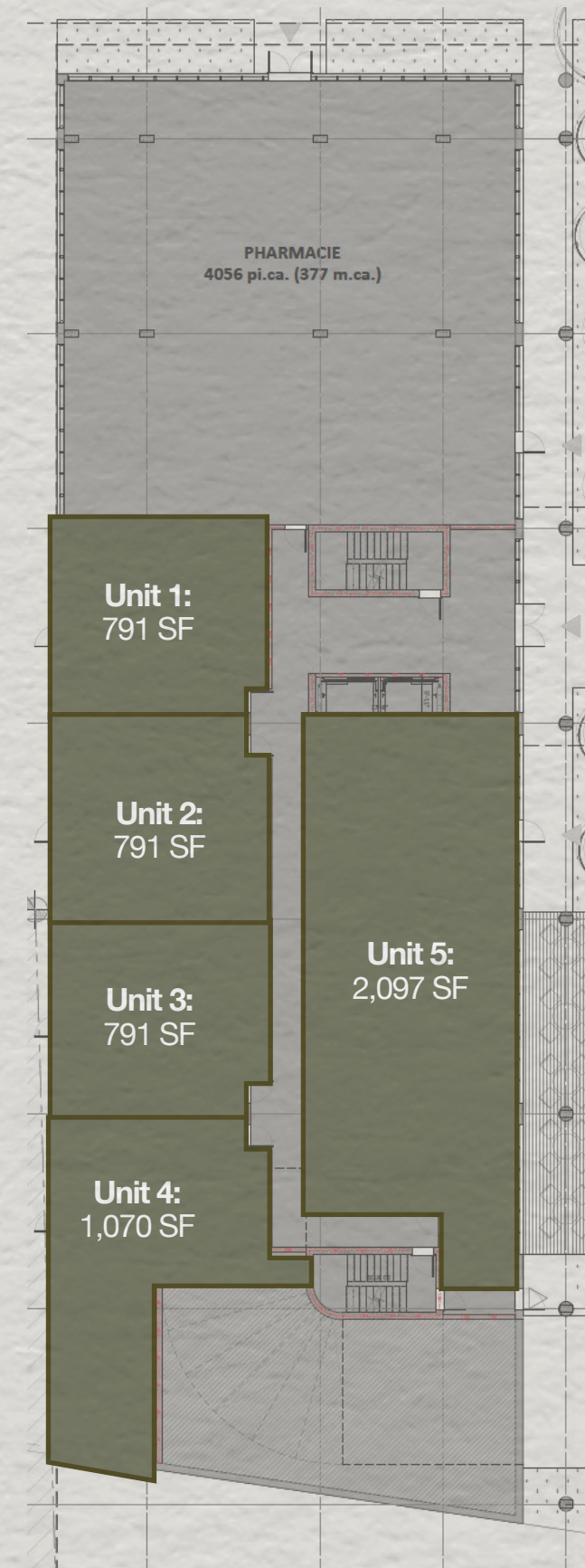

Map

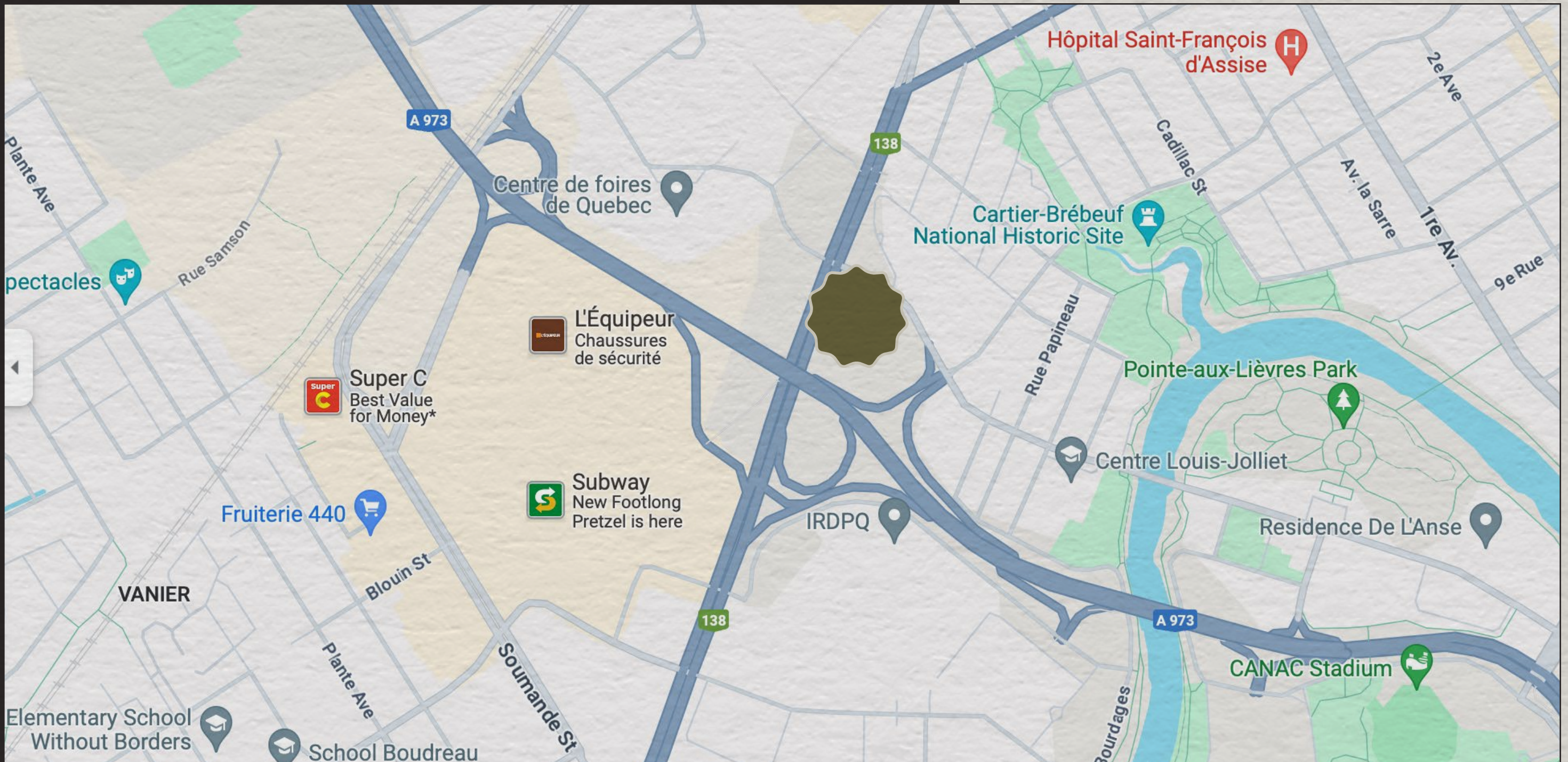

www.oberfeldsnowcap.com

OBERFELD SNOWCAP

Manon Larose *

Managing Director
Commercial Real Estate Services
438.990.8968
manonl@oberfeldsnowcap.com

Michelle Marcotte-Blart **

Director
Commercial Real Estate Services
514.972.6163
michelle@oberfeldsnowcap.com