

OBERFELD SNOWCAP

FOR LEASE ↘

445 Bd Sir-Wilfrid-Laurier
Mont St-Hilaire, QC

AERA St-Hilaire

Manon Larose *

Managing Director
Commercial Real Estate Services
438.990.8968
manonl@oberfeldsnowcap.com

*Chartered real estate broker, DA

Michelle Marcotte-Blart **

Director
Commercial Real Estate Services
514.972.6163
michelle@oberfeldsnowcap.com

**Commercial real estate broker



Overview

SQUARE FOOTAGE

Unit C1: 1,272 SF | Office Space : 482 SF

ADDRESS

445 Bd. Sir-Wilfrid-Laurier, Mont-Saint-Hilaire QC

AVAILABILITY

Immediate

NET RENT

Ask listing brokers

ADDITIONAL RENT

\$4.96 PSF

LOCATED AT THE BASE
OF 143 APARTMENTS



EASILY ACCESSIBLE,
MINUTES FROM H20



UNIT C1 IDEAL
FOR A CAFÉ



CLOSE TO THE TRAIN
STATION & BUS LINES



**OBERFELD
SNOWCAP**

Area Demographics

RADIUS : 5KM

2024 Population
58,533

Total Households
24,625

2024 Daytime Population
47,626

Average Household
Income
CA\$133,180

Median Age
44.3

Average Household
Expenditure
CA\$140,075



Key Facts

Demographic Data Source: Environics (2024)

Plan



Plan - C1

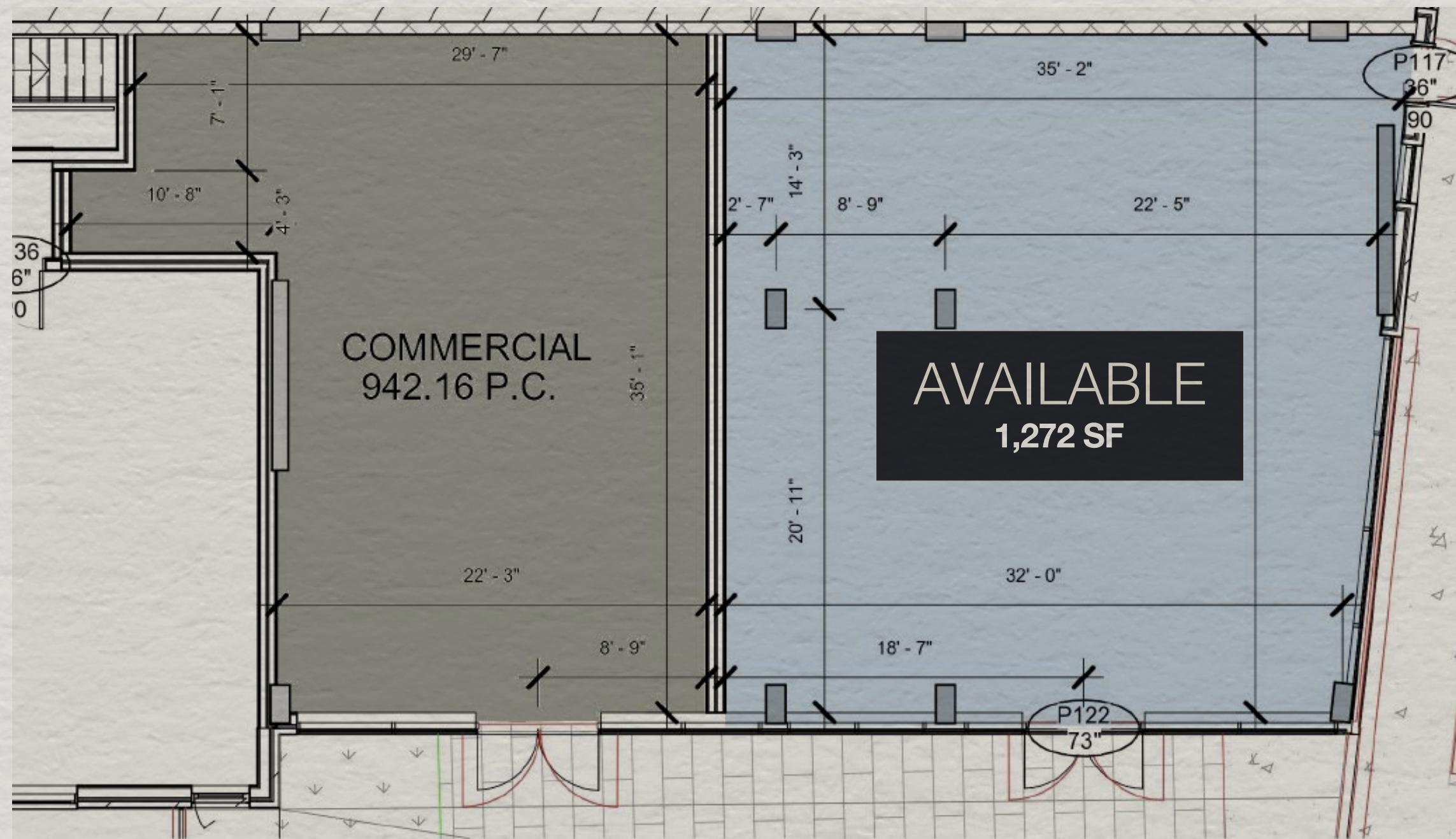

Plan - Office



Retailer Map



www.oberfeldsnowcap.com

OBERFELD SNOWCAP

Manon Larose *

Managing Director
Commercial Real Estate Services
438.990.8968
manonl@oberfeldsnowcap.com

Michelle Marcotte-Blart **

Director
Commercial Real Estate Services
514.972.6163
michelle@oberfeldsnowcap.com